

# Centrifugal 12/50 Pumps

The 12/50 with 12 or 24 V d.c. motor options have a choice of material combinations making them adaptable for quite a range of applications.

## Application

The compact size and robust construction of these pumps combined with a range of features, including heavy duty d.c. motors offer the ideal solution to demanding pumping problems such as,

- wash down on mixer trucks
- bus heating circulation
- construction plant - road rollers
- marine - water system, air conditioning systems, heat exchanger
- railway trains - water pressure systems

## Materials

Body	Brass
Impeller	Plastic or Brass
Pump shaft	Stainless Steel
Seal options	Nitrile/carbon/ceramic Nitrile/carbon/silicon Viton/carbon/silicon

## Operating Conditions

Max. liquid temp.	80°C
Min. liquid temp.	4°C
Max. suction lift	4.6 m
Max. ambient temp.	40°C
Max. viscosity	50 Secs redwood no. 1 9.5 centistokes

## Pump Connection Sizes

Inlet	G <sup>3</sup> / <sub>4</sub> Female
Outlet	G <sup>3</sup> / <sub>4</sub> Female

## Accessories

G <sup>3</sup> / <sub>4</sub> /1 Plastic Spring Loaded FootValve and Strainer	26704
---	-------



12/50

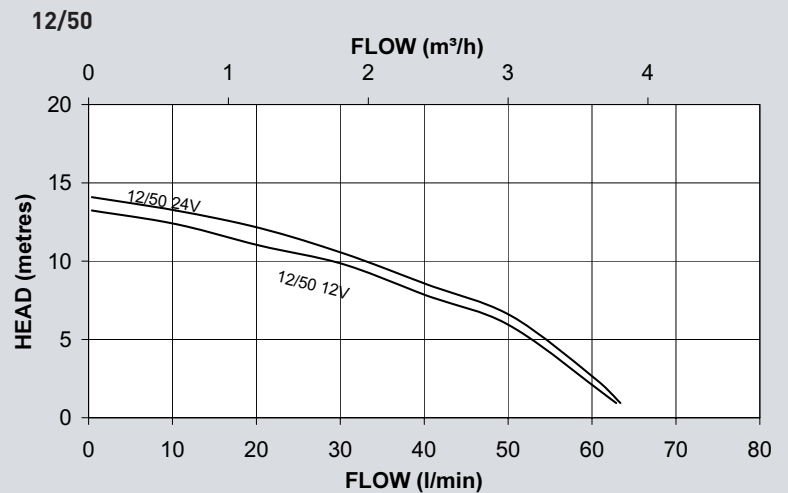

# Centrifugal 12/50 Pumps

Model	Motor	Nominal watts	Watts full flow	Amps full load	Impeller	Seal	Carton dims. mm			Gross weight (packed) Kg	Part no.
							L	x W	x H		
12/50	12V d.c.	125	200	16.7	Plastic	Nit/Car/Cer	330	x 190	x 190	3.4	46164
12/50	12V d.c.	125	200	16.7	Brass	Nit/Car/Cer	330	x 190	x 190	3.4	46166
12/50	12V d.c.	125	200	16.7	Brass	Vit/Car/Sil	330	x 190	x 190	3.4	46167
12/50	24V d.c.	175	210	8.8	Plastic	Nit/Car/Cer	330	x 190	x 190	3.4	46165
12/50 <i>c/w vent</i>	24V d.c.	175	210	8.8	Plastic	Nit/Car/Cer	330	x 190	x 190	3.4	46212
12/50	24V d.c.	175	210	8.8	Plastic	Nit/Car/Sil	330	x 190	x 190	3.4	46337
12/50	24V d.c.	175	210	8.8	Brass	Nit/Car/Cer	330	x 190	x 190	3.4	46168
12/50↔	24V d.c.	175	210	8.8	Brass	Nit/Car/Sil	330	x 190	x 190	3.4	46170
12/50	24V d.c.	175	210	8.8	Brass	Vit/Car/Sil	330	x 190	x 190	3.4	46169

↔ Denotes top horizontal position.

Both motors are built to IP44 using permanent magnet totally enclosed motor.

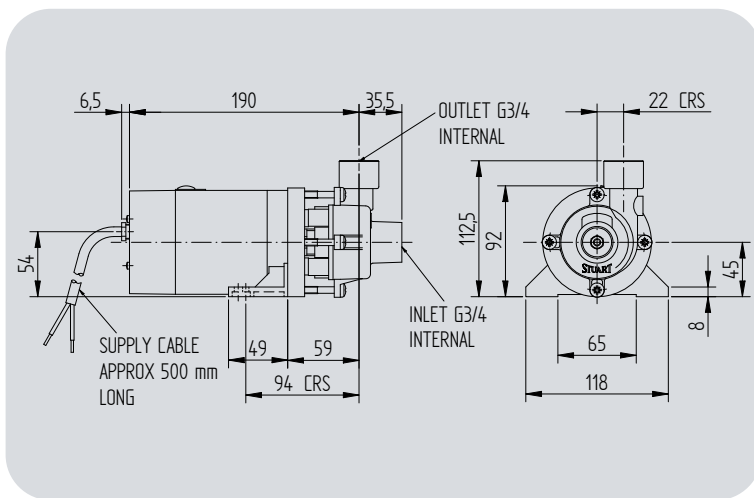

**12/50**

All dimensions shown are in mm.

Stuart Turner Ltd  
Henley-on-Thames  
Oxfordshire RG9 2AD  
England  
Telephone: +44 (0)1491 572655  
Fax: +44 (0)1491 573704

Email:  
pumps@stuart-turner.co.uk  
Web:  
www.stuart-turner.co.uk

V.A.T. REG. No. 199 0987 92.  
Registered in England No. 88368.  
Registered Office:  
Market Place, Henley-on-Thames

**STUART  
TURNER LTD**