

## Wear resistant submersible drainage pump for clear water and drainage water.

### H 125

#### Application

HOMA H 125 is wear resistant submersible drainage pump. This is the ideal solution to pump clear water or drainage water with abrasive sand or slurry. This is used to pump surface water from sumps, subway and building sites, for supply of industrial water, applications on board ships etc.

**Installation:** Transportable or permanent. Model with float switch control for automatic pump operation, depending on liquid level in the sump.

**Pumped liquid:** Clear water or drainage water with abrasive (eg. sand) solids. Max. liquid temperature: 35° C, short term up to 60° C.

#### Design

Fully submersible, compact integrated motor-pump unit consisting of:

**Pump:** Single stage centrifugal pump with horizontal discharge

**Impeller:** Open multi-channel impeller, spherical clearance 10 mm.

The distance between the impeller and casing can be readjusted to maintain maximum performance.

**Motor:** Fully submersible, pressure tight electric motor, oil-filled. Insulation class F. Degree of protection IP 68.

Cable connection chamber totally isolated from motor housing.

Cable: H 07 RN-F 4 G 1,5

**Shaft/Bearing:** Large diameter stainless steel rotor shaft, pre-lubricated bearings.

**Seals:** Combination of 2 mechanical seals in a separate oil chamber. Oil inspection from outside. Electrical seal control optional, also available with 3 lip seals.

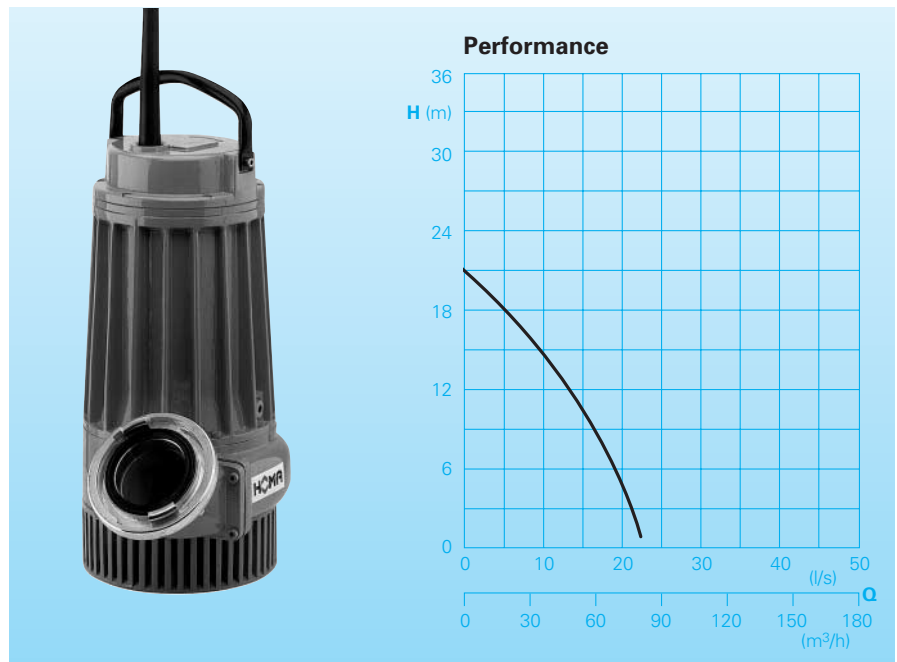

#### Technical Data

| Pump type   | Motor-<br>input<br>P <sub>1</sub> (kW) | Motor-<br>output<br>P <sub>2</sub> (kW) | Voltage<br>50 Hz<br>(V) | Discharge   | Nominal<br>current<br>(A) | Spherical<br>clearance (mm) | Weight<br>(kg) |
|-------------|----------------------------------------|-----------------------------------------|-------------------------|-------------|---------------------------|-----------------------------|----------------|
| H 125 D (A) | 3,5                                    | 2,8                                     | 400-415/3Ph             | BSP2 1/2" M | 7,4                       | 10                          | 36             |

**Speed:** 2900 rpm

**Cable length:** 20 m

**Model A:** With automatic level control  
HOMA-Nivomatik

| Materials:                                                                               |                                                      |
|------------------------------------------------------------------------------------------|------------------------------------------------------|
| Pump housing                                                                             | Aluminium rubberized                                 |
| Suction sieve, elbow,<br>motor bearing housing,<br>motor housing,<br>motor housing cover | Aluminium                                            |
| Impeller<br>bottom plate                                                                 | Cast iron<br>GG 25/EN-GJL-250                        |
| Rotor shaft, screws                                                                      | Stainless steel                                      |
| Mechanical seals                                                                         | Silicon-carbide,<br>Carbon-graphite/<br>chrome steel |
| Seal kit                                                                                 | Perbonane                                            |

#### Equipment supplied

**Model D (400-415 V/3 Ph):**  
Control box D32; DT32(33) fitted with overload protection, on-off-switch, 20 m of cable and phase inverter.  
Pump with 90° or 45° elbow (please confirm selection with order), STORZ-fixed coupling: Size B

**Model A:** With additional automatic level control, AS-float switch, with 20 m of cable, manual-auto switch and control box DA20/32(33).

## Dimensions

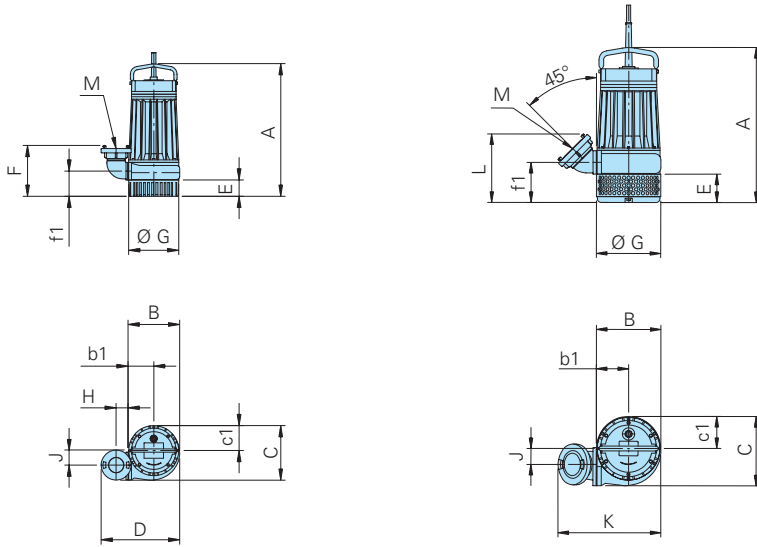

| Pump type | A   | B   | b1  | C   | c1  | D   | E  | F   | f1  | G   | H  | J  | K   | L   | M            |
|-----------|-----|-----|-----|-----|-----|-----|----|-----|-----|-----|----|----|-----|-----|--------------|
| H 125...  | 558 | 217 | 108 | 230 | 105 | 330 | 69 | 213 | 106 | 210 | 50 | 61 | 336 | 199 | BSP 2 1/2" F |

all dimensions in mm

## Accessories

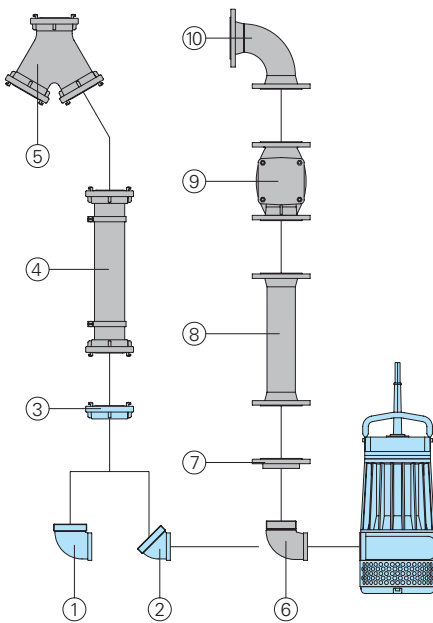

| Part Description                                           | Dimension                        | Part-No.                                 | Part Description                                                     | Dimension     | Part-No.   |
|------------------------------------------------------------|----------------------------------|------------------------------------------|----------------------------------------------------------------------|---------------|------------|
| ① 90° elbow                                                | BSP 2 1/2" M                     | Equipment supplied                       | ⑥ 90° elbow                                                          | BSP 4" M      | 6000830    |
| ② 45° elbow                                                | BSP 2 1/2" M<br>BSP 4 1/2" M     | Equipment supplied                       | ⑦ Screwed flange                                                     | DN100/BSP4" F | 2215100    |
| ③ STORZ-fixed coupling                                     | B-BSP 2 1/2" M<br>A-BSP 4 1/2" M | Equipment supplied                       | ⑧ Flanged discharge pipe with gasket and fixing bolts, per m         | DN100         | 2152201    |
| ④ Synthetic pressure hose with rubber lining and couplings | B- 75 mm Ø                       | 2611210<br>2611215<br>2611220<br>2611230 | Discharge pipe, per additional m                                     | DN 100        | 2150100    |
|                                                            | A- 110 mm Ø                      | 2611110<br>2611115<br>2611120<br>2611130 | ⑨ Flanged swing check valve with gasket and fixing bolts             | DN 100        | 2212809    |
| STORZ-hose coupling with spigot                            | B- 75 mm dia.<br>A- 110 mm dia.  | 2013502<br>2013801                       | ⑩ 90° flanged elbow                                                  | DN 100        | 2153303    |
| Reinforced hose, per m                                     | 75 mm dia.<br>110 mm dia.        | 2632075<br>2632110                       | ○ HOMA-Nivomatik float switch level control conversion kit           | AZD 10/20     | 1925452    |
| Hose band                                                  | 85/20<br>114/20                  | 2308520<br>2311520                       | ○ Control panel single or twin pump stations for automatic operation |               | On request |
| ⑤ STORZ-twin inlet with non-return valve                   | A-2B                             | 2016612                                  |                                                                      |               |            |
| STORZ-reducer                                              | A-B                              | 2015612                                  |                                                                      |               |            |
| ○ Coupling spanner                                         | A,B,C                            | 2016002                                  |                                                                      |               |            |

**HOMA**  
P U M P T E C H N O L O G Y

HOMA Pumpenfabrik GmbH  
P.O. Box 22 63, D-53814 Neunk.-Seelscheid  
Tel. +49(0)22 47/702-0, Fax +49(0)22 47/702-44  
e-mail: info@homa-pumpen.de  
www.homapumps.com